

Picture Perfect Supreme Art Lights

Style: Maintainable and adjustable high CRI lensed LEDs positioned on a rail as required to give a full & uniform canvas coverage with no damaging heat or UV emissions

IP Rating: IP20 (Indoor Use Only)

Construction: Extruded Aluminium (or Brass for Brass Options)

Finish: PA / PB / SS / SB / CG / ARB / ANB / BK / WH
Custom finishes including RAL colours and anodised plate finishes available upon request

Head Cross Section: 48mm x 46mm

Head Length: Sized specifically for canvas coverage (150mm - 3,000mm)
Larger sizes available upon request

Arm Length: Small / Medium / Long / Custom

Arm Style: Classic / Traditional / Straight / Custom

Arm Number: 150 - 650mm - 1 Arm
660 - 3,000mm - 2 Arms

Swivel Knuckle: To allow a 90 degree Tilt

Mounting Hardware: Wall / Frame Mount - Classic / Traditional / Custom Arm (1)
Rectangular / Round - Straight Arm (2 - 3)

Power: 24V Constant Voltage for both dimming and non-dimming options

Dimming Protocol: 0 - 10V, 1 - 10V, Dali, Lutron or Phase

Light Source: Multiples of 1.9W lensed LEDs sized to canvas

Colour Temperature: 2,700K (as standard) and 3,000K upon request

Colour Rendering: 98 CRI typical

Beam Angles: 15 / 30 / 40 / 45 / 60 selected to give greater coverage along with a secondary tilt action on LEDs allowing full canvas coverage

LED Life: 50,000 hours



Head Profile



48mm high x 46mm wide

Arm Options:

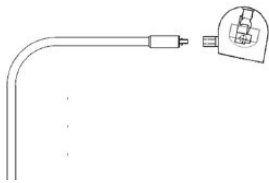

Classic Arm
Short / Medium / Long

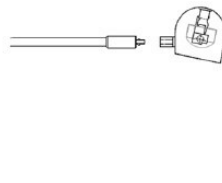

Straight Arm
Short / Medium / Long

Finish Options:

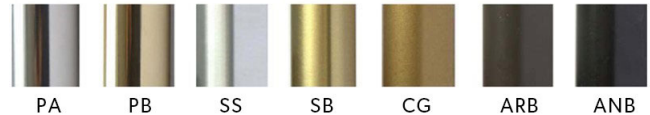

PA Polished Aluminium **PB** Polished Brass **SS** Satin Brushed Steel **SB** Satin Brushed Brass **CG** Classic Old Gold **ARB** Architectural Bronze **ANB** Antique Bronze **BK** Black **WH** White Other finishes available.

Mounting Hardware:

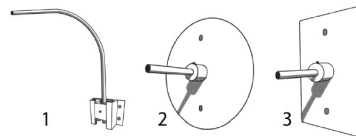

1. Wall or Frame (reversed) Mount – Classic Arm
2. Round Wall Mount – Straight Arm
3. Rectangular wall Mount – Straight Arm

Head & Arm Assembly

1 Arm 150 – 650mm
2 Arms 660 – 3000mm
Arm Diameter 6mm

